



9/5 Cora Lynn Court Lorne, VIC

 2  1  2

## FANTASTIC ENTRY POINT OPPORTUNITY WITH OCEAN VIEWS

This renovated two bedroom, one bathroom cottage is located 5km (3 min drive) from the hustle and bustle of Lorne's main township amenity and the stunning beach precinct.

**Price:** \$760,000

The home is part of a boutique cluster of properties that are all individually titled plus all have a share in 7 acres of common property that adjoins Otway National Park. The setting is simply stunning with an abundance of birdlife/wildlife and towering blue gums creating the relaxing lifestyle you should expect in this part of the coast.

The home also boasts a lovely blue water ocean view that cannot be built out.

Features include wrap around decking, large adjoining storage shed, ample car parking with

**Michael Coutts**  
0438 356 624

**Tyrone Provan**  
0405 124 799

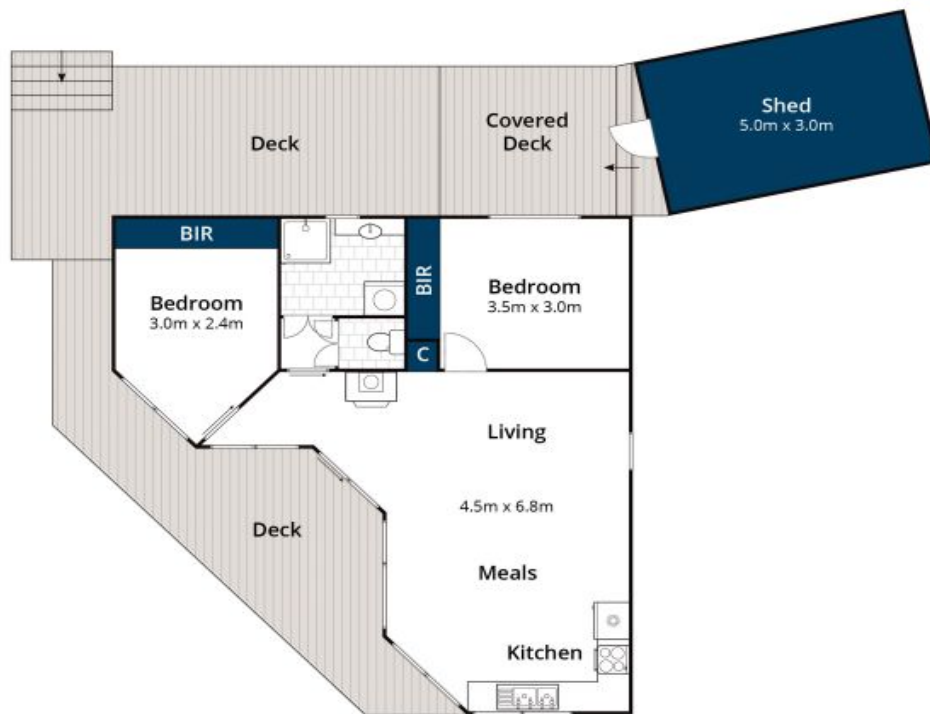

Approx House Area 97m<sup>2</sup>

Whilst [bwrn.com.au](http://bwrn.com.au) has made every attempt to ensure the accuracy of the floor plan contained here, measurements are approximate and no responsibility is taken for any error, omission, or mis-statement. This plan is for illustrative purposes only.

**9/5 Cora Lynn Court, Lorne**