

67 Lialeeta Road Fairhaven, VIC

 4
  3
  5

ABUTTING NATIONAL PARK AND ONLY 500M TO FAIRHAVEN ...

With National Park as your neighbour, your privacy is assured from this imposing, immaculately presented residence which excels for location, lifestyle and coastal living.

Where else along the Surf Coast can you abut National Park and yet be a short 6 minute stroll to a sensational beach without crossing the Great Ocean Road?

Possessing ocean views in one direction and captivating bush views in the other direction, and set on a large but low maintenance block of around 1840m², this double storey dwelling boasts generous accommodation upstairs of three bedrooms, main bathroom and ensuite, plus a generous laundry with a separate w/c.

Price:

Contact Agent

James Worssam

0418 585 815

Karen Stribling

0439 650 838

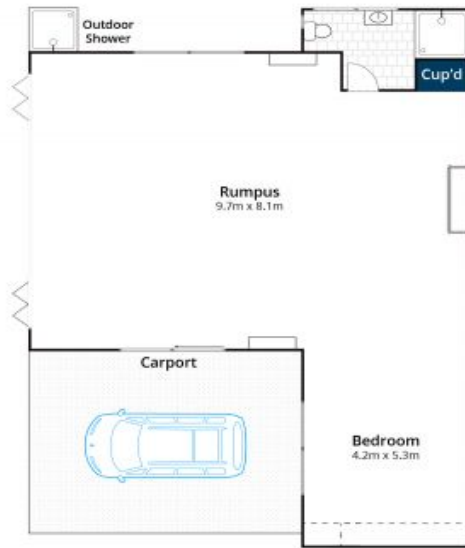

Lower Ground Floor



Ground Floor

Approx. Area 265m²

Whilst bwr.com.au has made every attempt to ensure the accuracy of the floor plan contained here, measurements are approximate and no responsibility is taken for any error, omission, or mis-statement. This plan is for illustrative purposes only.



67 Lialeeta Road, Fairhaven